

## Shaded-pole Motor

YZF Series shaded-pole motors are excellent technics. stable performance. We adopt high quality materials and there are several forms for choose, The ambient temperature of the shaded-pole motor is used from  $-25^{\circ}\text{C}$  to  $+50^{\circ}\text{C}$ , insulation rating class B, protection grade IP42 ,and it has been widely used in condensers, evaporators and other equipments

### Features

1. Each motor has a ground line
2. Thermal protection: Each motor below 10W with impedance protection, in addition, all motor above 10W equipped with thermal protector ( $135^{\circ}\text{C} \pm 5^{\circ}\text{C}$ )
3. Installation by screw holes on the end cover, or bracket installation, grid installation, flanged installation, also according to the special requirements
4. Custom-made motor with different voltage, frequency, wire length, bearings, special use of environment or other requirements are available

### Shaded-pole Motor Model Introduction

YZF - 5 - 13 - 00

1 2 3 4

1. Single-phase AC shade-pole motor
2. Rated output power
3. Silicon steel sheet thickness in mm
4. Distance of the installation between the feet

### Rotation Direction and Wind Direction

Observe rotation direction of fan blade from the shaft

Counter Clockwise

Clockwise

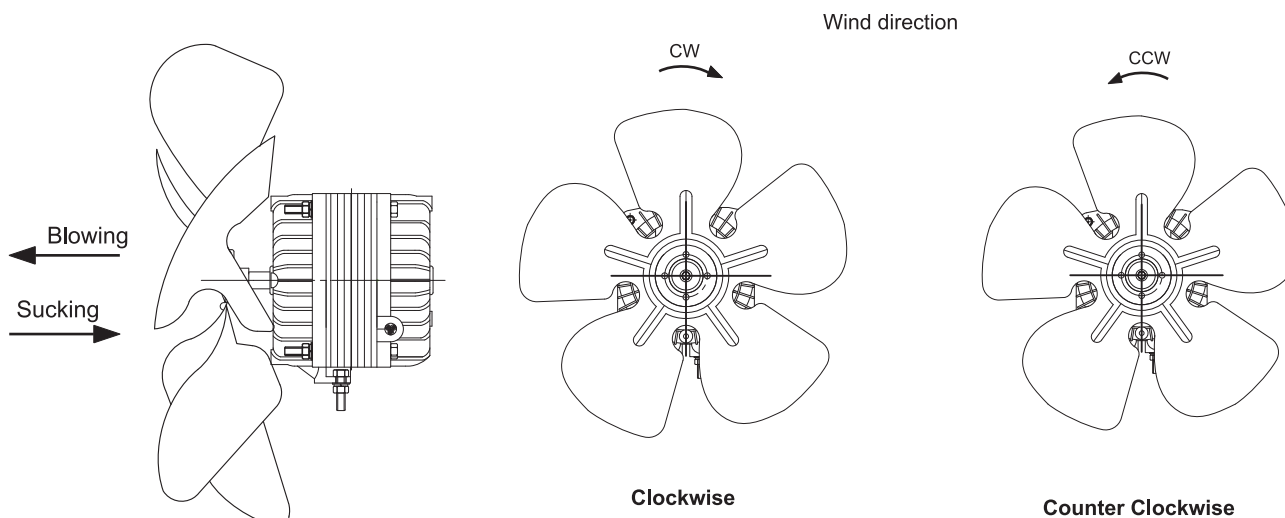

26-18 Series



Ball Bearings Series



Exquisite Appearance Series



YZF-7 Series

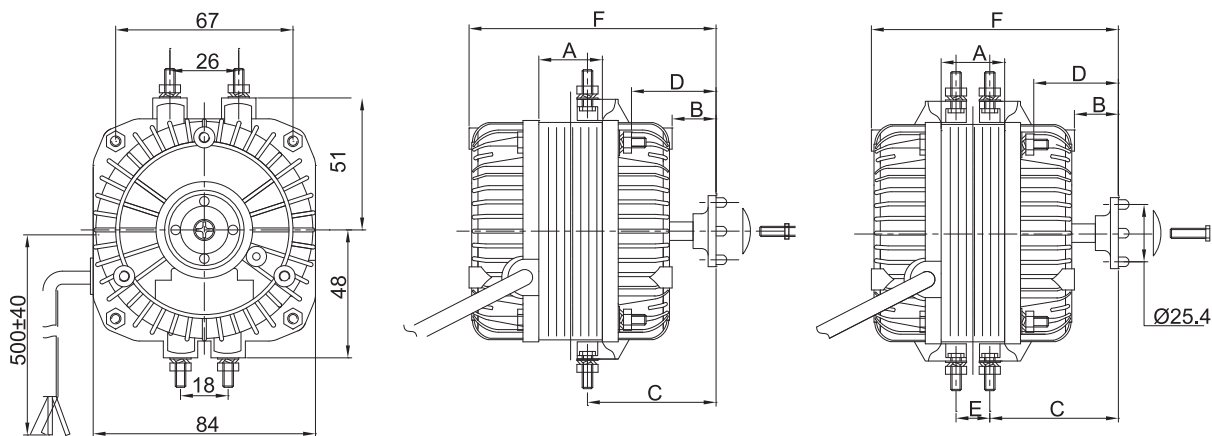

YZF-7 Series Shaded-pole Motor

YZF-7 Series Shaded-pole Motor						
Dimension (mm)	A	B	C	D	E	F
YZF-5-13	13	16	41	80	46	-
YZF-7-16	16	17	42	83	47	-
YZF-10-20	20	19	43	88	48	-
YZF-16-24	24	22	48	98	52	-
YZF-18-29	29	22	48	113	52	31
YZF-25-38	38	22	48	113	52	31
YZF-34-44	44	16	43	116	50	36

26-18 Series Shaded-pole Motor						
Dimension (mm)	A	B	C	D	E	F
YZF-5-13	13	11	44	25	-	78
YZF-7-16	16	14	45	28	-	84
YZF-10-20	20	15	48	29	-	89
YZF-16-24	24	16	49	30	-	94
YZF-18-29	29	19	52	33	18	102
YZF-25-38	38	19	52	33	26	111
YZF-34-44	44	18	51	32	32	116

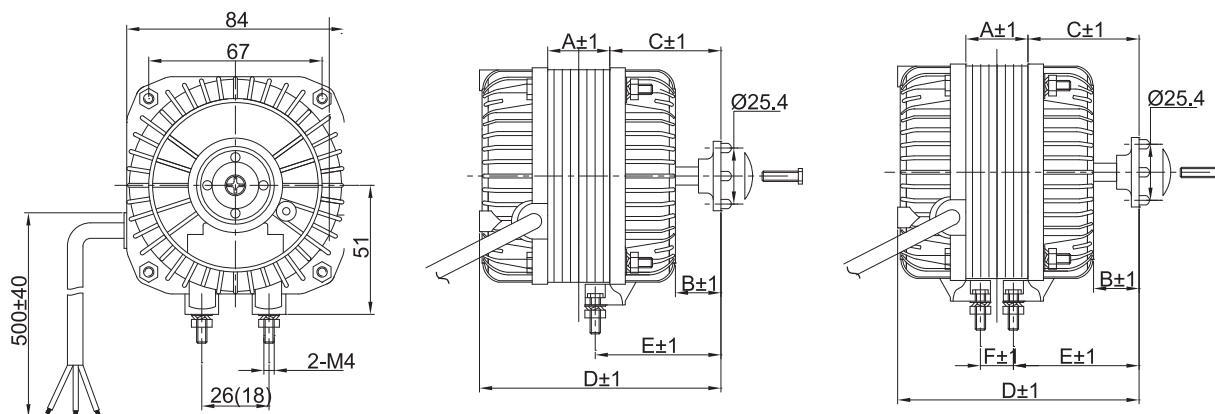

26-18 Series Shaded-pole Motor

Ball Bearings Series Shaded-pole Motor						
Dimension (mm)	A	B	C	D	E	F
YZF-5-13	13	16	41	80	46	-
YZF-7-16	16	17	42	83	47	-
YZF-10-20	20	19	43	88	48	-
YZF-16-24	24	22	48	98	52	-
YZF-18-29	29	22	48	103	52	-
YZF-25-38	38	22	48	113	52	-
YZF-34-44	44	16	43	116	50	-

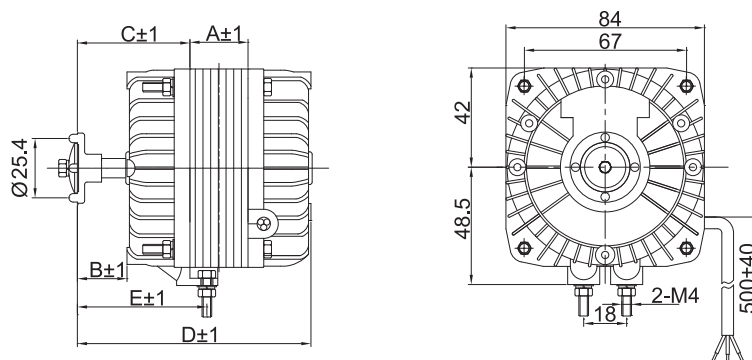

Ball Bearings Series Shaded-pole Motor

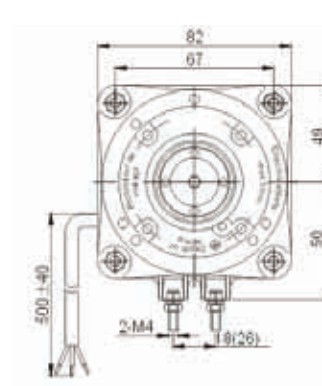
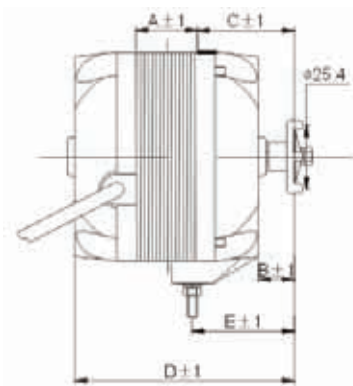
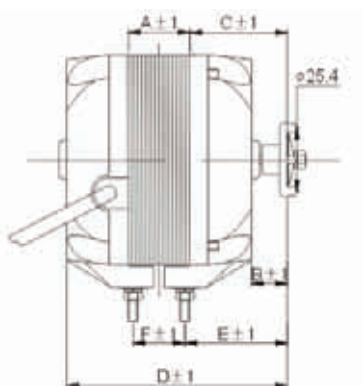
**Exquisite Appearance Shaded-pole Motor**

	A	B	C	D	E	F
YZF-5-13	13	16	41	80	46	-
YZF-7-16	16	17	42	83	47	-
YZF-10-20	20	19	43	88	48	-
YZF-16-24	24	22	48	98	52	-
YZF-18-29	29	22	48	103	52	26
YZF-25-38	38	22	48	113	52	31
YZF-34-44	44	16	43	116	50	36

**Technical Data**

Model	Voltage V	Frequency Hz	Current A	Power Input W	Power Output W	Speed rpm	Air Flow m <sup>3</sup> /h	Blade Size mm	Angle of Blade	Operative Range Pa
YZF-5-13	220	50	0.20	33	5	1300	280	170	28°	0-25
	220	60	0.20	33	5	1500	320	170	31°	0-30
	220	50/60	0.20	33	5	1300/1500	320/340	170	28°	0-25
	110	60	0.45	33	5	1500	420	200	25°	0-25
YZF-7-16	220	50	0.23	40	7	1300	380	200	28°	0-35
YZF-10-20	220	50	0.23	40	10	1300	500	200	28°	0-45
	220	60	0.25	40	10	1500	570	200	28°	0-55
	220	50/60	0.23	40	10	1300/1500	500/570	200	28°	0-30
	110	50	0.45	40	10	1300	580	230	22°	0-20
	110	60	0.5	40	10	1500	530	200	28°	0-30
YZF-16-25	220	50	0.43	60	16	1300	830	230	25°	0-40
	220	60	0.48	60	16	1500	730	230	22°	0-50
	220	50/60	0.46	60	16	1300/1500	760/850	230	25°	0-45
	110	60	0.80	60	16	1500	630	230	22°	0-25
YZF-18-30	220	50	0.48	75	18	1300	940	250	25°	0-40
	220	60	0.50	75	18	1500	870	250	22°	0-50
	110	50	0.90	75	18	1300	1030	300	19°	0-30
	110	60	0.95	75	18	1500	730	250	22°	0-30
YZF-25-40	220	50	0.65	100	25	1300	1480	300	25°	0-45
	220	60	0.90	155	25	1500	1400	300	19°	0-55
YZF-34-45	220	50	0.75	120	34	1300	1610	300	28°	0-45
	220	60	1.00	160	34	1500	1560	300	25°	0-55
	110	60	2.10	120	34	1500	1570	300	25°	0-40

## Accessories for Shaded-pole Motor Grid

Fan Type	C'	C	F	H	L
40W	277	264	222	39	70
60W	327	314	272	49	96
75W	337	324	280	49	100
90W	377	364	319	49	120

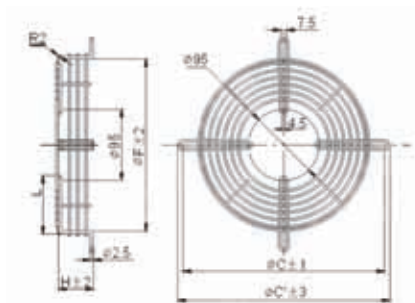
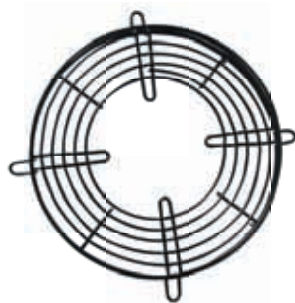

## Flange

Fan Type	ØA	ØB	C	ØD	E
172	223	180	49	208	25
200	246	208	49	236	25
230	278	238	49	266	25
254	300	262	49	290	25
300	378	308	49	365	30

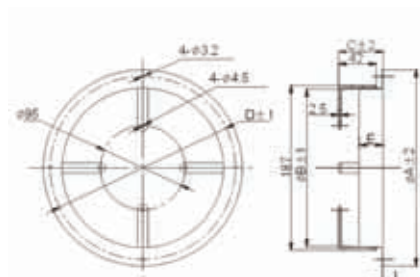

## Fan Blade

Fan Type	YZF5-13	YZF10-20	YZF16-25	YZF18-30	YZF25-40	YZF34-45
150	28	-	-	-	-	-
170	28	31	-	-	-	-
200	25	28	28	-	-	-
230	-	-	22	-	22	25
250	-	-	-	-	22	25
300	-	-	-	-	19	19



Fan Type	A	19°		22°		25°		28°		31°	
		B	C	B	C	B	C	B	C	B	C
150	150	-	-	-	-	-	-	33	17	-	-
172	170	25	13	28	14	31	16	34	17	38	19
200	196	27	14	30	15	33	17	36	18	40	20
230	228	30	16	33	17	36	18	39	20	42	21
250	244	31	16	34	17	37	19	40	20	43	22
300	298	37	18	41	21	44	22	48	24	52	26

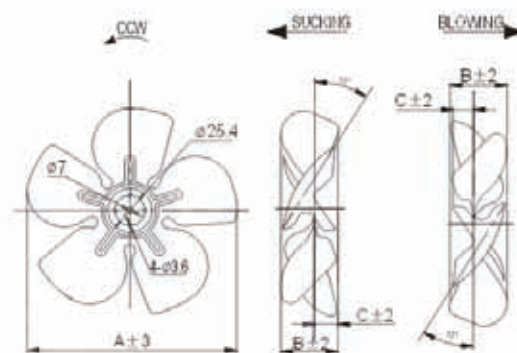

## Bracket

Model	H	L	L1	L2	M
H56	56	105	17	24	75
H72	72	105	13	24	75
H84	84	105	20	24	75
H84	84	166	18	25	126
H90	90	110	17	24	80
H110	110	106	14	42	83
H110	110	106	14	50	83

